



VU Case Rentals

ATE, Plastec Midwest, EW, D&MMW, GMX, MD&M Midwest
 September 28-30, 2010
Deadline Date To Receive Discounted Rates:
September 1, 2010

Please Mail or Fax Completed Form to RES:
 9291 West Bryn Mawr, Rosemont, IL 60018
 Fax: 847-696-9797
 Phone: 847-696-2208

FULL VISION CASE

Includes 1-8" and 1-10" glass shelf with adjustable brackets, 26" high front glass display section

	QTY.	DISCOUNT	STANDARD	TOTAL
5 ft.	_____	\$325.00	\$375.00	_____
6 ft.	_____	\$350.00	\$400.00	_____

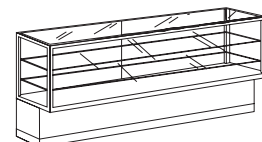

FULL VISION CASE

HALF VISION CASE

Includes 1-10" glass shelf with adjustable brackets, 18" high front glass display section

5 ft.	_____	\$325.00	\$375.00	_____
6 ft.	_____	\$350.00	\$400.00	_____

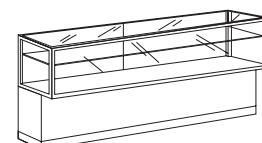

HALF VISION CASE

QUARTER VISION CASE

with 12" high front glass display section

5 ft.	_____	\$325.00	\$375.00	_____
6 ft.	_____	\$350.00	\$400.00	_____

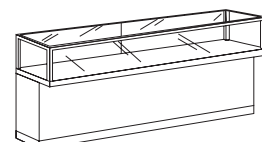

QUARTER VISION CASE

CORNER VISION CASE

Rear access, glass shelves same as above

Full Vision	_____	\$350.00	\$400.00	_____
1/2 Vision	_____	\$325.00	\$375.00	_____
1/4 Vision	_____	\$325.00	\$375.00	_____

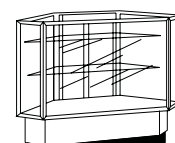

CORNER FULL VISION

WALL CASES ARE:

48"L x 20"D x 66"H, with 4-12" glass shelves, adjustable brackets, lights, locks and 60" high sliding glass doors

Solid	_____	\$350.00	\$400.00	_____
See-Thru	_____	\$350.00	\$400.00	_____

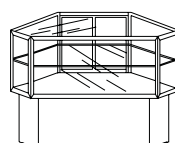

CORNER 1/2 VISION

TOWER CASES

20"L x 20"D x 80"H, with 3 glass, lights, and locks

20" x 20" Sq.	_____	\$350.00	\$400.00	_____
---------------	-------	----------	----------	-------

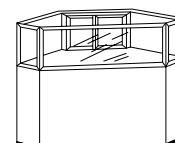

CORNER 1/4 VISION

Order Total \$

All showcases are 20" D x 38" H, have lights, locks, sliding mirror doors, gray exterior, off-white interior aluminum frames.

4' showcases available upon request. (limited quantities)

Electrical hook-up is not included. Please order the outlet from electrical contractor.

A \$50.00 charge per showcase for late orders and changes made at showsite.

All keys must be left with showcase or a charge of \$10.00 will be assessed.

A \$20.00 charge per additional shelf or size change of shelf.

For detailed information and questions, please call VU Case Rentals, Inc. at 630-766-7443

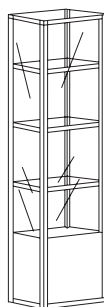

TOWER CASE

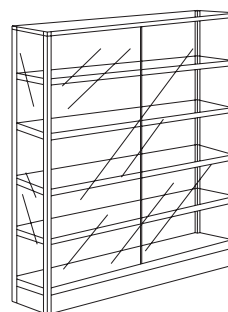

WALLCASE SOLID AND SEE-THRU

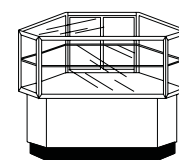

CORNER 1/2 VISION

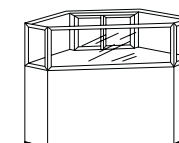

CORNER 1/4 VISION

Company Name: _____ Phone #: _____ Fax #: _____
 Address: _____ City: _____ State: _____ Zip: _____
 Authorized By (print): _____ Signature: _____ Booth #: _____

Order Summary and Payment Sheet MUST accompany this order. All terms and conditions as outlined on the Order Summary and Payment Sheet have been reviewed and understood.

RES Address: 9291 West Bryn Mawr Rosemont, IL 60018 • RES Telephone: 847-696-2208 • RES Fax: 847-696-9797